



# PRODUCT DATA SHEET

## Coaxial Cable Connect: DIN-M7/8

### Description

DIN(M) Connector for 7/8" Cable

### Suitable standard

IEC 60169-4

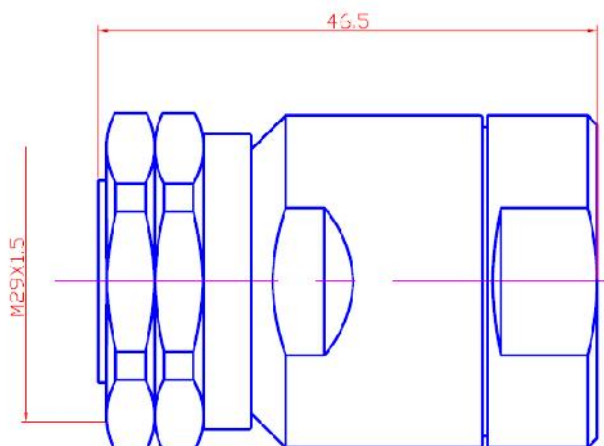

### MATERIALS & PLATING

	Description	Material	Surface Plating	Remark
1	Shell/Body	BRASS	Nickel or Tri-Allory	
2	Center Conductor	BRASS	Gold or Silver	
3	Insulator	PTFE		

### ELECTRICAL CHARACTERISTICS

	Item	Technical Data
1	Impedance	50Ω
2	Frequency range max	DC-3 GHz
3	Contact Resistance	Center conductor $\leq 0.4\text{m}\Omega$ , Outer conductor $\leq 1\text{m}\Omega$
4	Insulation Resistance	$\geq 10000\text{M}\Omega$
5	VSWR	DC~3GHz $\leq 1.1$

### MECHANICAL CHARACTERISTICS

1	Durability	$\geq 500$ cycles
---	------------	-------------------

### ENVIRONMENTAL CHARACTERISTICS

1	Temperature range	Cable: - 40°C to +100 °C
---	-------------------	--------------------------