

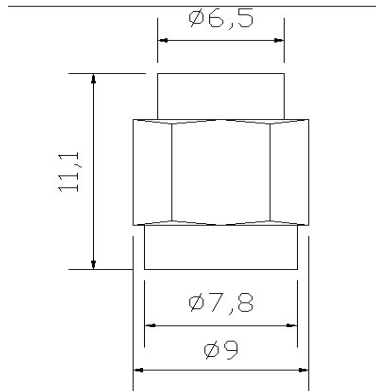

Sunny 50 Ohm SMA(M) Type 1W Dummy Load For 6/18GHz

Model : SMA-50M-1-YY

Where YY is Frequency range : 6G, 18G



Product Specification

Model	SMA-50M-1-YY	
Frequency Range	DC-6GHz	DC-18GHz
V.S.W.R.	≤ 1.25	≤ 1.30
Impedance	50 Ω	
Max Power (CW Avg)	1W	
Connector	SMA(M)	
Ambient Temperature	-20 to +60 °C	
Environment	Indoor	
Dimension	See Above	
Connector Material	Brass	

Technical data are subjected to change without notice – File : SMA-50M-1-YY 2016V1.0